

Introduced by: Paul Barden

No: 78-320

6/8/78

ORDINANCE NO. 3726

AN ORDINANCE making an appropriation to the County Road Construction Fund in the amount of \$34,000 from State Department of Transportation payments in the amount of \$16,900 and from a transfer from the County Road Fund in the amount of \$17,100 for Pacific Highway South-Drainage Study; revising the 1978 Capital Improvement program and amending Ordinance No. 3492, Section 73, Attachment No. 1, as amended.

BE IT ORDAINED BY THE COUNCIL OF KING COUNTY:

SECTION 1. There is hereby approved and adopted an appropriation to the County Road Construction Fund of \$34,000 from State Department of Transportation Payments in the amount of \$16,900 and transfer from the County Road Fund in the amount of \$17,100 for Pacific Highway South-Drainage Study, Capital Improvement Project No. 800878.

SECTION 2. There is hereby approved and adopted an appropriation of \$17,100 from the unappropriated fund balance of the County Road Fund to "Transfer to Fund 386", Capital Improvement Project No. 999977 to provide the county share of the project identified in Section 1 above.

SECTION 3. Ordinance 3492, Section 73, as amended is hereby amended to read as follows:

County Road (CIP Only)	(((\$1,742,000))	<u>\$1,759,100</u>
County Road Construction	(((\$2,922,500))	<u>\$2,956,500</u>

Project: 800878 - Pacific Hwy. South-Drainage Study

Description:

Council District: 008
CIP Planning Area: Federal Way

LOCATION: South 312th Street to South 338th Street

WORK SCOPE: Storm Water Drainage Design Study with participation by Washington State Department of Transportation per "GC 4458" as amended.

OBJECTIVE: To identify limits of drainage basin area, sources and anticipated runoff rates - to recommend methods to deal and handle such runoff

LENGTH: Area Study

Cost Data:

Status:

Original Cost Estimate (1977) \$24,000
Current Cost Estimate (1978) 34,000 Design only

Study proposed to start 2nd Quarter 1978

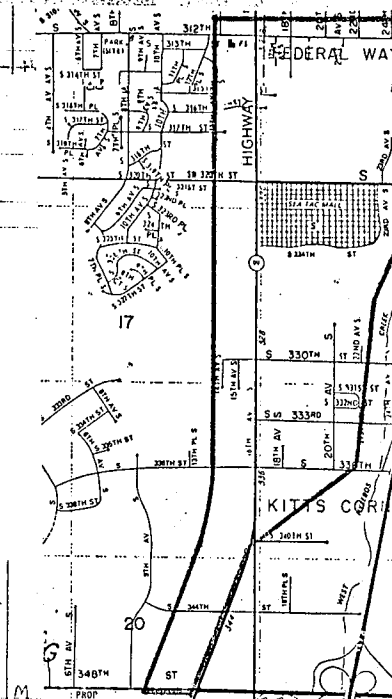

Project Data:

FUND	000003860 County Road Construction	AGENCY	70	RESPONSIBLE ORG -	1695
DEPT	0737 County Road			DEPARTMENT PRIORITY REQUEST	
FUNCTION	54100 Road & Street Construction			LOCATION -	So. 312th St. to So. 338th St.
SERVICE	54157 Specialized Projects			CIP PLANNING AREA -	005 Federal Way
PROGRAM	54177 Discrete Projects			COUNCIL DISTRICT -	008

OPTION	***** CAPITAL IMPROVEMENTS *****			*** PROGRAM PROJECTION IN THOUSANDS OF DOLLARS ***				
	PRIOR YEAR	EXISTING	1978	1979	1980	1981	1982	1983
	EXPENDITURES	BUDGET	REQUEST					

- | | |
|-------------------------|----------|
| 1. DESIGN, PRELIM ENG. | \$34,000 |
| 2. ACQUISITION OR R/WAY | |
| 3. CONSTRUCTION | |
| 4. EQUIP & FURNISHINGS | |
| 5. CONTINGENCY | |
| 6. ARTISTIC FURNISHINGS | |

EXPENDITURE TOTAL 0 \$34,000

REVENUES

33920 (A) State Payments	16,900
37203 (A) Cont. Co. Ros.	17,100

REVENUE TOTAL 0 \$34,000

TOTAL PROJECT COST ESTIMATE \$ 34,000

TOTAL REVENUE AVAILABLE \$ 34,000

Description:

Council District: _____

CIP Planning Area: _____

A cash transfer of County Road Fund balance contained in the County Road Fund No. 00103 to the newly established County Road Construction Fund No. 00386. This transfer will provide the County portion of funding required for all the recommended 1977 "New Start" Road Projects budgeted in the County Road Construction Fund No. 00386.

Cost Data:

Status:

Project Data:

FUND 000001030 County Road Road	AGENCY	RESPONSIBLE ORG
DEPT 0734 Roads - Construction		DEPARTMENT PRIORITY REQUEST
FUNCTION 54100 Road & Street Constructn		LOCATION - Not Applicable
SERVICE Specialized Projects		CIP PLANNING AREA - 016 Undefined Area
PROGRAM Project Contingency		COUNCIL DISTRICT - 010

OPTION	***** CAPITAL IMPROVEMENTS *****			*** PROGRAM PROJECTION IN THOUSANDS OF DOLLARS***				
	PRIOR YEAR EXPENDITURES	EXISTING BUDGET	1978 REQUEST	1979	1980	1981	1982	1983
1. DESIGN, PRELIM ENG.								
2. ACQUISITION OR R/WAY								
3. CONSTRUCTION								
4. EQUIP & FURNISHINGS								
5. CONTINGENCY		\$1,017,796	1,618,100					
6. ARTISTIC FURNISHINGS								

EXPENDITURE TOTAL

REVENUES SOURCES

30110 (A) BEG UNENCUMBERED FUND BAL	29,296	220,100	
31121 (A) REAL PRP DVRTD RD TAX-CUR	\$988,500	1,398,000	
REVENUE TOTAL	2,635,896		
TOTAL PROJECT COST ESTIMATE	2,635,896		
TOTAL REVENUE - AVAILABLE	2,635,896	PENDING	\$